

802.3bt DCDC PoE Injector

Features

- 40-72VDC Input, 802.3bt 112W Output
- Industrial Temperature Range: -40 to +70C
- Up to 5Gigabit Data Passthru with Surge Protection
- DIN Rail Mounting (Adapters Included)

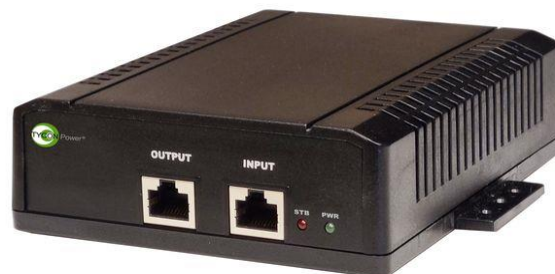

Applications

- 48VDC or -48VDC Remote Power Systems
- IEEE802.3bt Industry Standard Device Power from Batteries
- PoE Lighting Applications



Description

The TP-DCDC-4856GD-BT is a 5Gbps high power DCDC converter and PoE injector with a wide voltage input range (40-72VDC), a wide operating temperature range (-40 to +70C) and a high power 802.3bt 112W output.

The unit has dual DC inputs for primary and backup power sources. The input to output is isolated so the unit can accept -48VDC Input, making it compatible with legacy telecom systems. The green DC connector accepts wires up to 12AWG. The "FG" input is used to provide chassis or earth ground.

The device is fan-less and uses natural air flow for cooling. It comes with DIN rail adapters to provide mounting to a standard DIN Rail commonly used in industrial installations. It can also be wall mounted.

Device Pinouts

RJ-45 Input (Data Only)			RJ-45 Output (Data & Power)	
Pin	Symbol	Description	Symbol	Description
1	BI_DA+	Data Pair A+	BI_DA+, VDC-	Data Pair A+, POE -
2	BI_DA-	Data Pair A-	BI_DA-, VDC-	Data Pair A-, POE-
3	BI_DB+	Data Pair B+	BI_DB+, VDC+	Data Pair B+, POE+
4	BI_DC+	Data Pair C+	BI_DC+, VDC+	Data Pair C+, POE+
5	BI_DC-	Data Pair C-	BI_DC-, VDC+	Data Pair C-, POE+
6	BI_DB-	Data Pair B-	BI_DB-, VDC+	Data Pair B-, POE+
7	BI_DD+	Data Pair D+	BI_DD+, VDC-	Data Pair D+, POE-
8	BI_DD-	Data Pair D-	BI_DD-, VDC-	Data Pair D-, POE-

Specifications

TP-DCDC-4856GD-BT	
Input Voltage	+/- 40V to 72VDC, Dual Inputs
Input Current	3.6A @ 40VDC IN (Full Load) 2.6A @ 56VDC IN (Full Load) 2.0A @ 72VDC IN (Full Load)

Output Voltage	IEEE802.3bt 56VDC ; Load Reg = 5%, Line Reg = 1%
Output Current / Max Watts	2.0A / 112W
Ripple & Noise	1%
Efficiency	>80% 40-72VDC Input
Protections	Short Circuit, Reverse Voltage, Over Voltage (59V)
Over Current Protection	110 ~ 130% ; Auto Recover
Low Voltage Detect (LVD)	Device with stop drawing all current when input voltage drops below 33.2VDC
Misc Protections	Short Circuit, Reverse Voltage
Data PassThrough	10/100/1000/5000Mbps ; Gigabit
Data Protection	Pin to Pin (1-2, 3-6, 4-5, 7-8) Clamp Voltage: 3.3V ESD, IEC61000-4-2: +/- 30KV contact and air EFT, IEC61000-4-4: 40A (5/50us) Lightning, IEC61000-4-5: 15A (8/20us)
MTBF	123,821 Hrs
Safety Standards	UL 1950 ; CSA 22.2 ; TUV EN60950-1
EMC Standards	FCC Class A ; EN55022 Class A
Connections	Removable Wire Terminal
Wire Size	12AWG Max
LED Function	Green Power LED = Valid 802.3bt Detection Red STB LED = Input Power OK, No valid 802.3bt Detection
Mounting	Wall Mount or DIN Rail (Adapters Included)
Operating Temperature	-40C to +70C (-40F to 158F)
Humidity (RH)	5% - 90% Non-Condensing
Dimensions (LxWxH)	140 x 150 x 40 mm (5.5" x 5.9" x 1.6")
Weight	0.6kg (1.30lb)
Warranty	3 Years

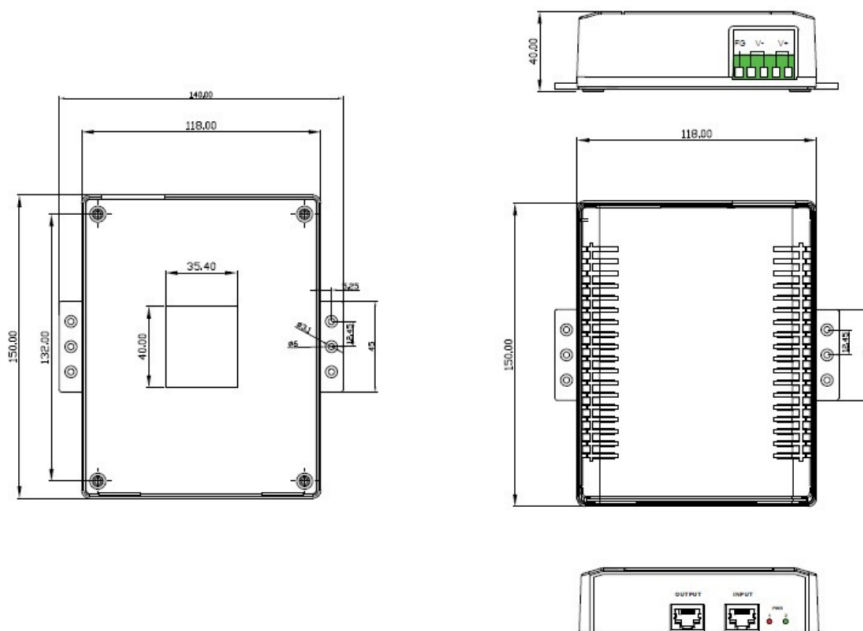
**Ordering:****TP-DCDC-4856GD-BT**

DC to DC, 40-72VDC IN, 802.3bt 112W Out, Gigabit PoE Injector

For further information contact:Tyconsystems.com